

### PX-W120 12Volt 6.5Ah

#### ● Specifications

Nominal Voltage		12V
Rated capacity (20 hour rate)		6.5Ah
Dimensions	Length	151±1.5mm(5.94inch)
	Width	65±1mm(2.56inch)
	Height	94±1mm(3.70inch)
	Total Height	100±1mm(3.94inch)
Approx. Weight		2.0kg(4.41lbs)±4%

#### ● Outer dimensions (mm)

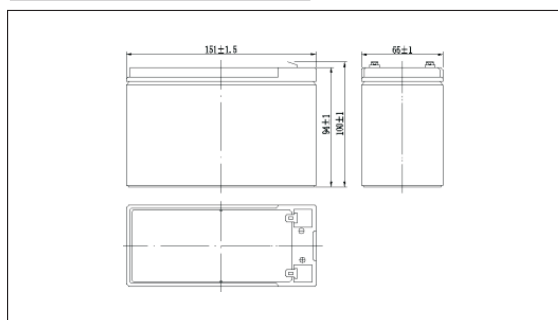

#### ● Terminal Type (mm)

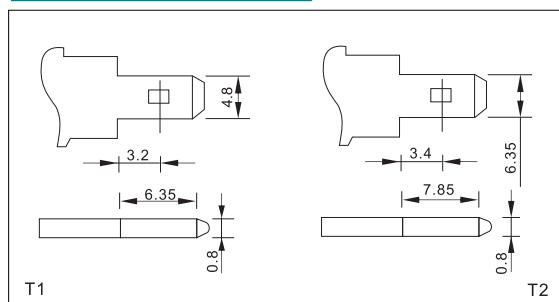

#### ● Construction

Component	Positive plate	Negative plate	Container	Cover	Separator	Electrolyte	Safety valve	Terminal
Raw material	Lead dioxide	Lead	ABS	ABS	AGM	Sulfuric acid	Rubber	Copper

#### ● Constant Current Discharge Characteristics Unit:A(25°C,77°F)

F.V/Time	5min	10min	15min	30min	60min	2h	3h	4h	5h	10h	20h
9.60V	21.7	13.7	10.7	6.04	3.71	2.26	1.56	1.29	1.10	0.60	0.32
9.90V	21.0	13.3	10.5	5.92	3.66	2.24	1.55	1.28	1.09	0.59	0.32
10.2V	20.1	12.8	10.1	5.74	3.57	2.22	1.54	1.28	1.08	0.59	0.32
10.5V	19.3	12.2	9.73	5.60	3.49	2.19	1.53	1.27	1.08	0.59	0.32
10.8V	18.2	11.5	9.22	5.39	3.39	2.13	1.48	1.23	1.04	0.58	0.31

#### ● Constant Power Discharge Characteristics Unit:W(25°C,77°F)

F.V/Time	5min	10min	15min	30min	60min	2h	3h	4h	5h	10h	20h
9.60V	242	155	122	69.2	43.0	26.4	18.6	15.4	13.1	7.16	3.84
9.90V	234	150	119	67.8	42.4	26.3	18.4	15.3	13.0	7.13	3.82
10.2V	225	144	115	65.7	41.3	26.0	18.3	15.2	13.0	7.10	3.80
10.5V	215	138	111	64.2	40.5	25.6	18.2	15.1	12.9	7.05	3.78
10.8V	203	130	105	61.8	39.2	25.0	17.6	14.6	12.5	6.91	3.70

Note: The above characteristics data can be obtained within three charge or discharge cycles.

#### ● Characteristics

Capacity (25°C)	20HR(10.5V)	6.5Ah
	10HR(10.5V)	5.9Ah
	1HR(9.60V)	3.7Ah
Terminal type		T1/T2
Internal resistance (Fully charged,25°C)		Approx.35m Ω
Capacity affected by temperature (20HR)	40°C	102%
	25°C	100%
	0°C	85%
	-15°C	65%
Self-discharge (25°C)	3 months	Remaining Capacity:91%
	6 months	Remaining Capacity:82%
	12 months	Remaining Capacity:65%
Nominal operating temperature		25°C ±3°C(77°F ±5°F)
Operating temperature range	Discharge	-15°C~50°C(5°F~122°F)
	Charge	-10°C~50°C(14°F~122°F)
	Storage	-20°C~50°C(-4°F~122°F)
Float charging voltage(25°C)		13.50 to 13.80V Temperature compensation: -18mV/°C
Cyclic charging voltage(25°C)		14.50 to 15.00V Temperature compensation: -30mV/°C
Maximum charging current		1.95A
Maximum discharge current		97.5A(5 sec.)
Designed floating life(20°C)		5 years

# POWER-XTRA

## RECHARGEABLE SEALED LEAD ACID BATTERY

### PX-W120 12Volt 6.5Ah

● Discharge characteristics(25°C)

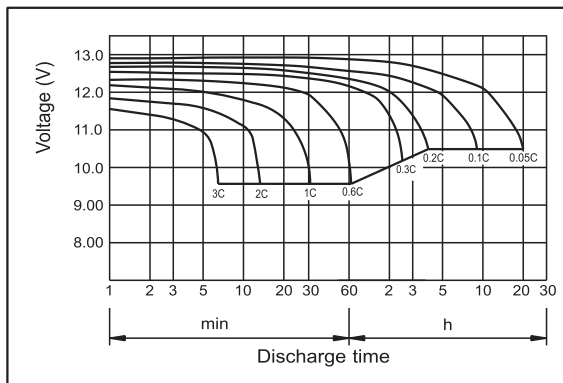

● Charging characteristics (25°C)

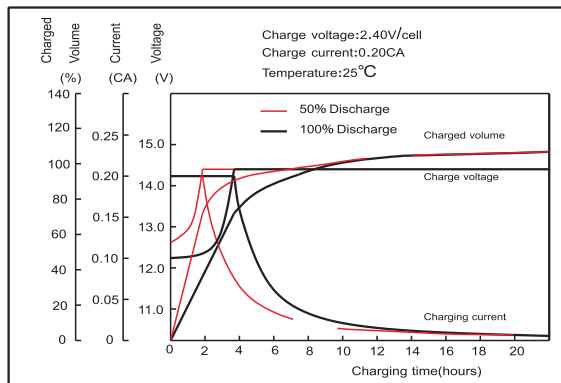

● Effect of temperature on capacity

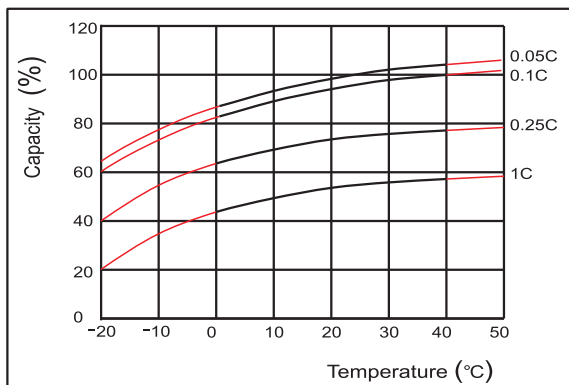

● Self-discharge characteristics

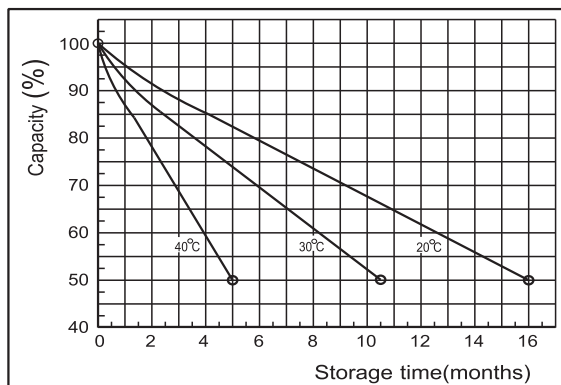

● Floating life on temperature

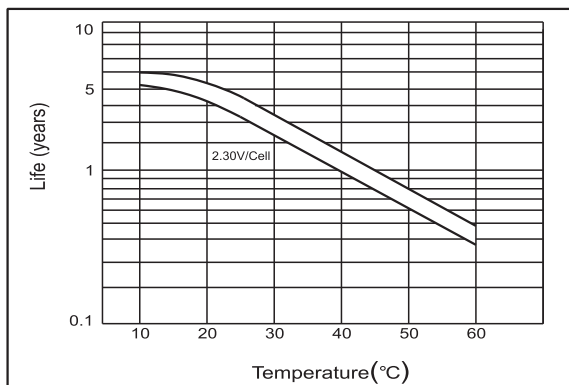

● Cycle life on D.O.D (25°C)

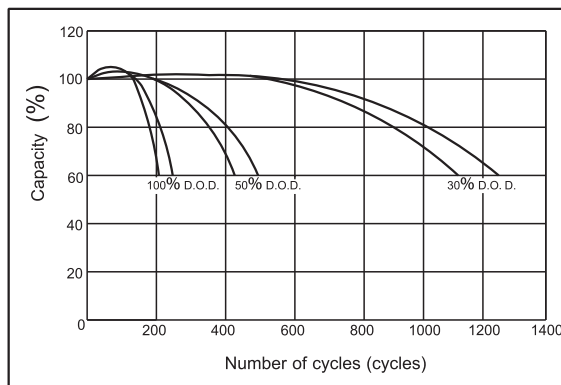

● The relationship for OCV and residual capacity (25°C)

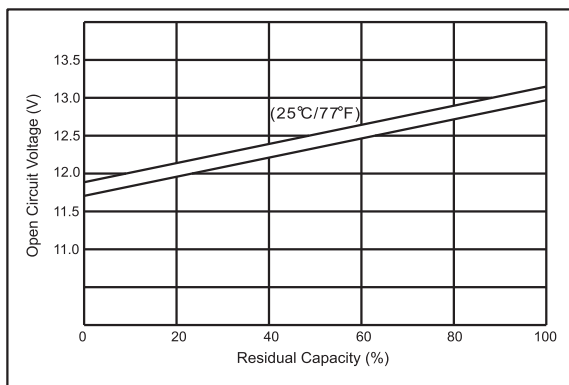

● The relationship for charging voltage and temperature

