

## GEL RECHARGEABLE BATTERY FOR HIGH RATE USE



### General Features

- Silica gel technology for longer cycle life and better performance at cold ambient temperatures.
- Special sheet separator and colloidal or foamed silica.
- Deep discharge cycle increased by 50% as compared with the AGM battery.
- High reliability and quality.
- Excellent recovery from deep discharge.
- Living up prevailing standards.

### Dimensions and Weight

Length(mm / inch)	485 / 19.09
Width(mm / inch)	172 / 6.77
Height(mm / inch)	240 / 9.45
Total Height(mm / inch)	240 / 9.45
Approx. Weight(Kg / lbs)	48.5/106.9
Standard Terminal	I

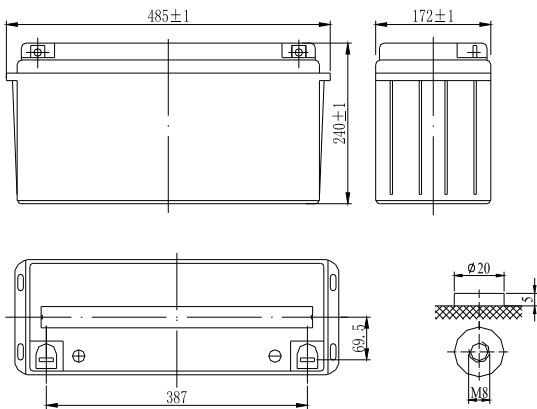

### Specification

Nominal Voltage	12V
Number of cell	6
Design Life	10 years
Nominal Capacity 77°F(25°C)	
20hour rate (7.5A,10.5V)	150AH
10hour rate (14.3A,10.5V)	143AH
5 hour rate (28.2A,10.5V)	141AH
1 hour rate (88A,9.6V)	99AH
Internal Resistance	
Fully Charged battery 77°F(25°C)	3.7mOhms
Self-Discharge	
3% of capacity declined per month at 20°C(average)	
Operating Temperature Range	
Discharge	-20~60°C
Charge	-10~60°C
Storage	-20~60°C
Max. Discharge Current 77°F(25°C)	1000A(5s)
Short Circuit Current	2700A
Charge Methods: Constant Voltage Charge 77°F(25°C)	
Cycle use	14.4-14.7V
Maximum charging current	45A
Temperature compensation	-30mV/°C
Standby use	13.6-13.8V
Temperature compensation	-20mV/°C

### Discharge Constant Current (Amperes at 77°F25°C)

End Point Volts/Cell	5min	10min	15min	30min	1h	3h	5h	10h	20h
1.60V	525	360	262	157	99.0	40.9	28.6	14.9	7.77
1.65V	472	328	255	153	98.8	40.8	28.4	14.6	7.70
1.70V	448	316	246	150	98.5	40.6	28.3	14.5	7.61
1.75V	399	292	232	147	97.5	40.5	28.2	14.3	7.50
1.80V	360	271	222	142	96.3	40.3	27.9	14.0	7.38

### Discharge Constant Power (Watts at 77°F25°C)

End Point Volts/Cell	5min	10min	15min	30min	1h	3h	5h	10h	2h
1.60V	865	597	465	297	195	78.6	54.7	31.8	51.9
1.65V	820	589	460	291	188	78.5	54.6	31.3	51.6
1.70V	766	574	453	283	183	78.4	54.5	31.1	51.2
1.75V	714	537	426	276	181	77.4	54.1	30.6	50.9
1.80V	640	499	400	268	178	76.3	53.2	30.0	50.4

### Discharge characteristic (25°C)

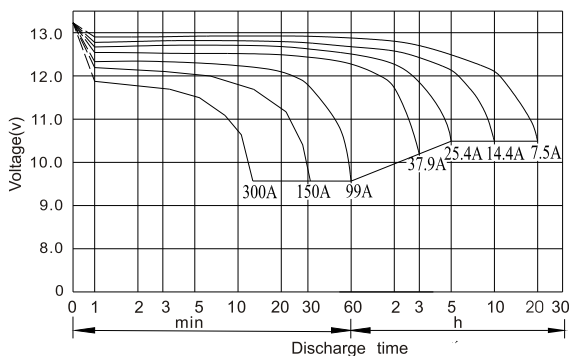

### Constant voltage charging characteristic (0.25CA, 25°C)

